



Hozelock UK Garden Irrigation & Automatic Watering Systems



aquauno LOGICA PLUS

AUTOMATIC
TIMER WITH
PRE-SET
WATERING
CYCLES

INSTRUCTIONS
MANUAL

8411



claber®

I

1

UK

14

F

27

D

40

E

53

P

66

S

79

NL

92

GR

105

AQUAUNO LOGICA

THANK YOU FOR CHOOSING OUR TIMER. CAREFULLY READ THE INSTRUCTIONS MANUAL BEFORE PROGRAMMING. EACH SECTION CONTAINS ALL THE INFORMATION REQUIRED FOR THE CORRECT EXECUTION OF EACH OPERATION.

LEGENDA:

0 = STAND BY = WAITING POSITION
 EVERY = EVERY WEEK
 WEEK = WEEK
 MIN = MINUTES
 H = HOURS

- ① WASHABLE FILTER
- ② 3/4" THREAD FEMALE CONNECTOR
- ③ SINGLE-CONTROL KNOB
- ④ TIMER UNIT COVER
- ⑤ QUICK-CLICK SYSTEM FITTING
- ⑥ LED

CE DECLARATION OF CONFORMITY

WE DECLARE UNDER OUR SOLE RESPONSIBILITY THAT THIS PRODUCT IS IN CONFORMITY WITH THE FOLLOWING STANDARDS OR STANDARDIZATION DOCUMENT: EN 55022/CEI ENV 501 40 TO THE PROVISIONS OF THE REGULATIONS 89/336/ EEC.

CE 97

DANIELE PAPAIS



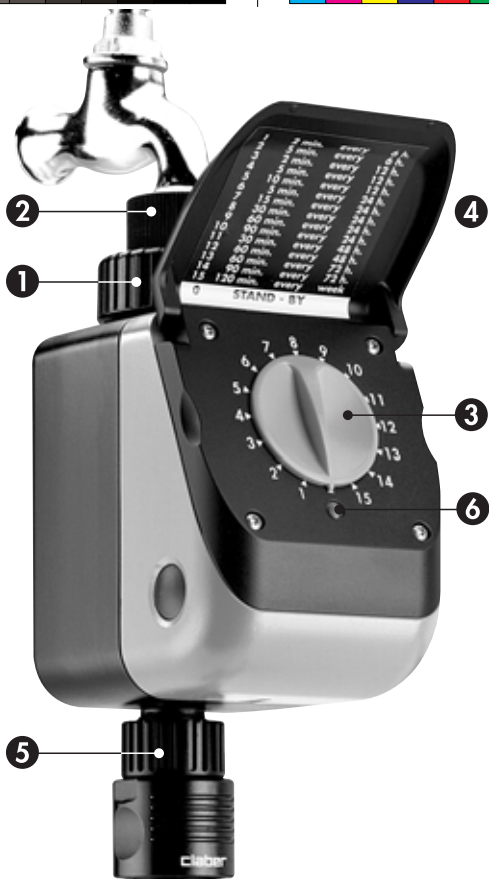



UK
16

CONNECTION TO THE TAP

UNSCREW EXTERNAL RING NUT **C** AND TIGHTEN 3/4" FEMALE CONNECTOR **A** ON 3/4" TAB **B**.
FIX THE TIMER TO THE TAP BY TIGHTENING RING NUT **C**.

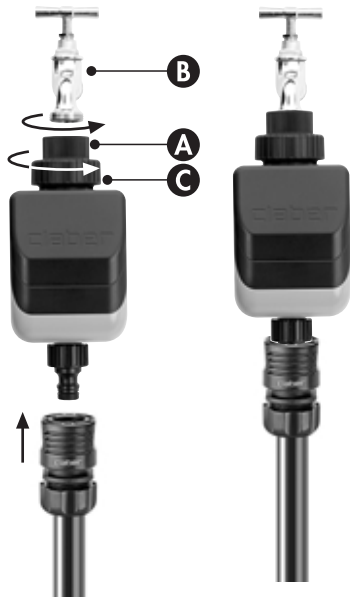



WATER PRESSURE TABLE

UK
17

BAR	0,5	1	2	2,5	3	4	5
l/min	11	16	22	25	27	31	35

VOLTAGE -POWER TABLE

1x 9 VOLT ALKALINE BATTERY.

DURATION: THIS BATTERY IS SUFFICIENT TO POWER THE TIMER FOR AN ENTIRE SEASON WITH AN AVERAGE OF 4 DAILY WATERING CYCLES.

TO PREVENT THE RISK OF CORROSION CAUSED BY ACID, REMOVE THE BATTERY FROM THE TIMER DURING PERIODS OF THE INACTIVITY.

WHEN THE CHARGE IS TOO LOW, THE TIMER AUTOMATICALLY INTERRUPTS OPERATION BY CLOSING THE SOLENOID VALVE.

N.B. DUE TO A NUMBER OF THE EXTERNAL FACTORS WHICH MAY CAUSE SUDDEN DELETION, BATTERY CHARGE CONSUMPTION IS DIFFICULT TO ESTIMATE. IT IS THEREFORE A GOOD IDEA TO REPLACE THE BATTERY AT THE BEGINNING OF EACH SEASON.



UK
18

SINGLE-CONTROL KNOB





19

SIMPLY ROTATE THE SINGLE-CONTROL KNOB TO ONE OF THE 15 NUMBERED NOTCHES (1 TO 15) TO SELECT ANY OF THE **15** PRESET WATERING PROGRAMS. IF THE LED FLASHES ABOUT EVERY 2 SECONDS, THE BATTERY IS CHARGED; IF IT REMAINS OFF, THE BATTERY HAS TO BE CHANGED (WE ADVISE YOU ALWAYS TO CHANGE THE BATTERY ONCE A YEAR).

1	2 min.	every	6 h.
2	5 min.	every	6 h.
3	2 min.	every	12 h.
4	5 min.	every	12 h.
5	10 min.	every	12 h.
6	5 min.	every	24 h.
7	15 min.	every	24 h.
8	30 min.	every	24 h.
9	60 min.	every	24 h.
10	90 min.	every	24 h.
11	30 min.	every	48 h.
12	60 min.	every	48 h.
13	60 min.	every	72 h.
14	90 min.	every	72 h.
15	120 min.	every	week
0	STAND - BY		

EXAMPLE:

POSITION 3 = 2 MINUTES OF WATERING EVERY 12 HOURS. IF THE PROGRAM IS SET TO 18:00 HOURS THE START TIME IS DELAYED BY 10 SECONDS AND REPEATS AFTER 12 HOURS (IN THIS CASE AT 6:00 HOURS THE FOLLOWING DAY).



UK
20

FITTING THE BATTERY

USING THE TWO SIDE BUTTONS ON THE FRONT PANEL, SIMPLY DISCONNECT AND PRESS-FIT THE BATTERY TERMINALS.

MAKE SURE THAT THE BATTERY (9 V.) IS CORRECTLY POSITIONED IN ITS HOUSING.

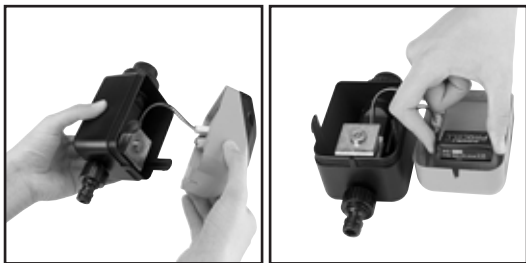





PROGRAMMING

UK
21

THE WATERING TIMES OF THE 15 PRESET CYCLES PERMIT CALIBRATED WATERING TO SUIT THE DIFFERENT REQUIREMENTS OF THE PLANTS ACCORDING TO THE SPECIES AND ENVIRONMENT.

1 WARNING: THE SELECTED PROGRAM STARTS IMMEDIATELY (WITH A DELAY OF 10 SECONDS)

2 WARNING: IF THE NEW PROGRAM IS SET THE VALVE CLOSES IF OPEN AND THE NEW WATERING CYCLE COUNT STARTS.

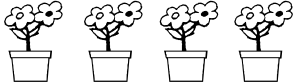
FOR EXAMPLE:		
	7 5 8	
	7 5 8	
	3 6 4	

FUNZIONE MANUALE/STAND-BY

IF THE KNOB IS SET TO ONE OF THE 15 SELECTABLE PROGRAMS, AFTER 10 SECONDS THE TIMER ACTS LIKE AN ORDINARY TAP. TO STOP THE WATER SIMPLY TURN THE KNOB TO 0 (STANB-BY).

IMPORTANT: THIS FUNCTION CANCELS THE PROGRAM PREVIOUSLY SET, THEREBY MAKING IT NECESSARY TO REPROGRAM THE TIMER (SEE PAGE 21). IF THE SINGLE-CONTROL KNOB IS LEFT SET TO 0 (STAND-BY) , THE TIMER REMAINS INACTIVE.

INSTRUCTIONS

- DO NOT ALLOW THE APLIANCE TO FREEZE OVER.
- DO NOT USE AQUAUNO LOGICA ON HOSES CONTAINING CHEMICAL SUBSTANCES OR ANY LIQUID OTHER THAN WATER
- DO NOT OPERATE AQUAUNO LOGICA WHEN INLET PRESSURE EXCEEDING 10 BAR.
- ONLY USE NEW ALKALINE BATTERIES.
- WHEN NOT PROGRAMMING, KEEP THE COVER CLOSED TO PROTECT THE DISPLAY FROM EXPOSURE TO SUNLIGHT AND HUMIDITY.
- AT LEAST ONCE A SEASON, CLEAN THE SINTHETIC FOAM FILTER UNDER RUNNING WATER. IN THE CASE OF HARD OR RAIN WATER, THE FILTER MUST BE CLEANED MORE FREQUENTLY



CONNECTING TO A RAIN SENSOR

UK
23

THE AQUAUNO LOGICA CAN BE CONNECTED TO A RAIN SENSOR (CLABER CODE 90915). THE RAIN SENSOR CUTS OFF THE AQUAUNO LOGICA WATERING PROGRAM IN CASE OF RAIN, RESTORING IT AUTOMATICALLY WHEN THERE IS NO MORE WATER LEFT IN THE SENSOR.

THE RAIN SENSOR MUST BE CONNECTED TO THE TWO SPECIAL ELECTRICAL CONTACTS PROVIDED INSIDE THE AQUAUNO LOGICA PROGRAMMING MODULE, USING THE CONNECTOR SUPPLIED WITH THE SENSOR. THE TWO-WIRE CABLE MUST BE FED IN THROUGH THE SEAT PROVIDED IN THE BOTTOM OF THE AQUAUNO LOGICA. BEFORE FITTING THE CONNECTOR, REMOVE THE JUMPER PLACED OVER THE TWO CONTACTS. FOR THE CONNECTION DIAGRAM, SEE RIGHT.



VALVE A

VALVE B

BATTERY

SENSOR



CONNECTOR SUPPLIED
WITH THE RAIN SENSOR

UK
24

claber®

SERVICE	SERVICE	SERVICE
1	2	3

WARRANTY

THE WATER TIMER IS WARRANTED FOR A PERIOD OF TWO YEARS FROM THE DATE OF PURCHASE, THAT IS CERTIFIED BY THE INVOICE OR RECEIPT WHEN PURCHASING.

THE WARRANTY IS VOID IF THE PRODUCT HAS BEEN DAMAGED BY ACCIDENT, MISUSE OR ABUSE OR IN LACK OF THE BILL SHOWING THE PURCHASE DATE.

WRITE THE SERIE NUMBER

--	--	--	--	--	--	--

PLEASE TURN OVER FOR THE GENERAL CONDITIONS OF WARRANTY.



GENERAL CONDITIONS OF WARRANTY



CLABER GUARANTEES THAT ITS APPLIANCE DOES NOT PRESENT DEFECTS REGARDING THE MATERIALS EMPLOYED AND CONSTRUCTION. DURING THE 24-MONTH PERIOD FOLLOWING THE DATE OF DELIVERY TO THE CUSTOMER, CLABER SHALL EITHER REPLACE OR REPAIR THE DEFECTIVE PRODUCT FREE OF CHARGE IF THE APPLIANCE HAS BEEN EMPLOYED IN NORMAL WORKING CONDITIONS, IF MAINTENANCE HAS BEEN CARRIED OUT BY AUTHORIZED PERSONNEL AND IF IT HAS NOT BEEN MODIFIED IN ANY WAY. CLABER SHALL NOT BE LIABLE FOR DAMAGE DUE TO THE CUSTOMER'S MISUSE OR TO ERRORS OCCURED DURING INSTALLATION. FOLLOW THE INSTRUCTIONS AND INSTALLATION PRESCRIPTIONS REGARDING THE USE OF OUR PRODUCT.

CLABER SHALL NOT BE LIABLE FOR DAMAGE OF PRODUCTS MANUFACTURED BY OTHER COMPANIES EVEN IF COMBINED WITH THEIR APPLIANCES. THE PRODUCT CAN BE MAILED TO OUR ASSISTANCE CENTER ONLY IF THE CUSTOMER HAS BEEN AUTHORIZED TO DO SO; THE RISKS WHICH OCCUR DURING TRANSPORT ARE ENTIRELY CHARGED TO THE CUSTOMER. REFER TO THE GENERAL SALES CONDITIONS IN FORCE WHATEVER ELSE SHOULD OCCUR. FOR ANY FURTHER INFORMATION ON OUR SERVICING, YOU MAY CONTACT CLABER SPA
TEL. 0039/0434/958836 - FAX 0039/0434/957193.
P.O. BOX 159 - 33170 PORDENONE - ITALY.

www.claber.com
info@claber.com

claber®